

22/01146/FUL

Demolition of the former Prince of Wales public house and the erection of a 72 bedroom care home facility with frontage parking together with the change of use of former agricultural land at the rear to ancillary amenity space for residents including the provision of Green Care Farming with landscaping, and associated works. (Cross boundary application - Solihull and Bromsgrove).

Prince Of Wales Public House, High Street, Solihull, B90 1JW

Recommendation: Grant subject to s106

Site Location Plan

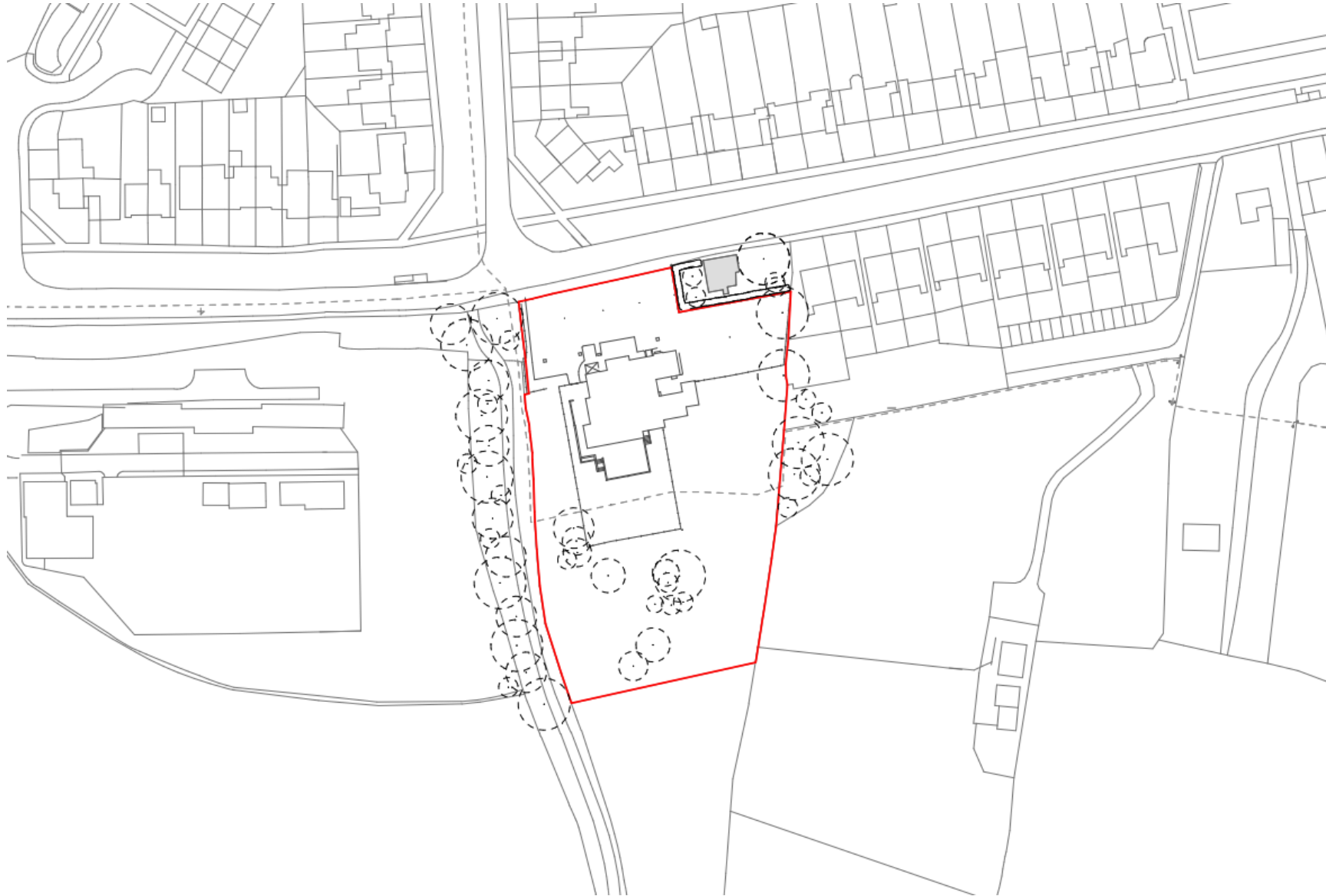

BDP Proposals Map

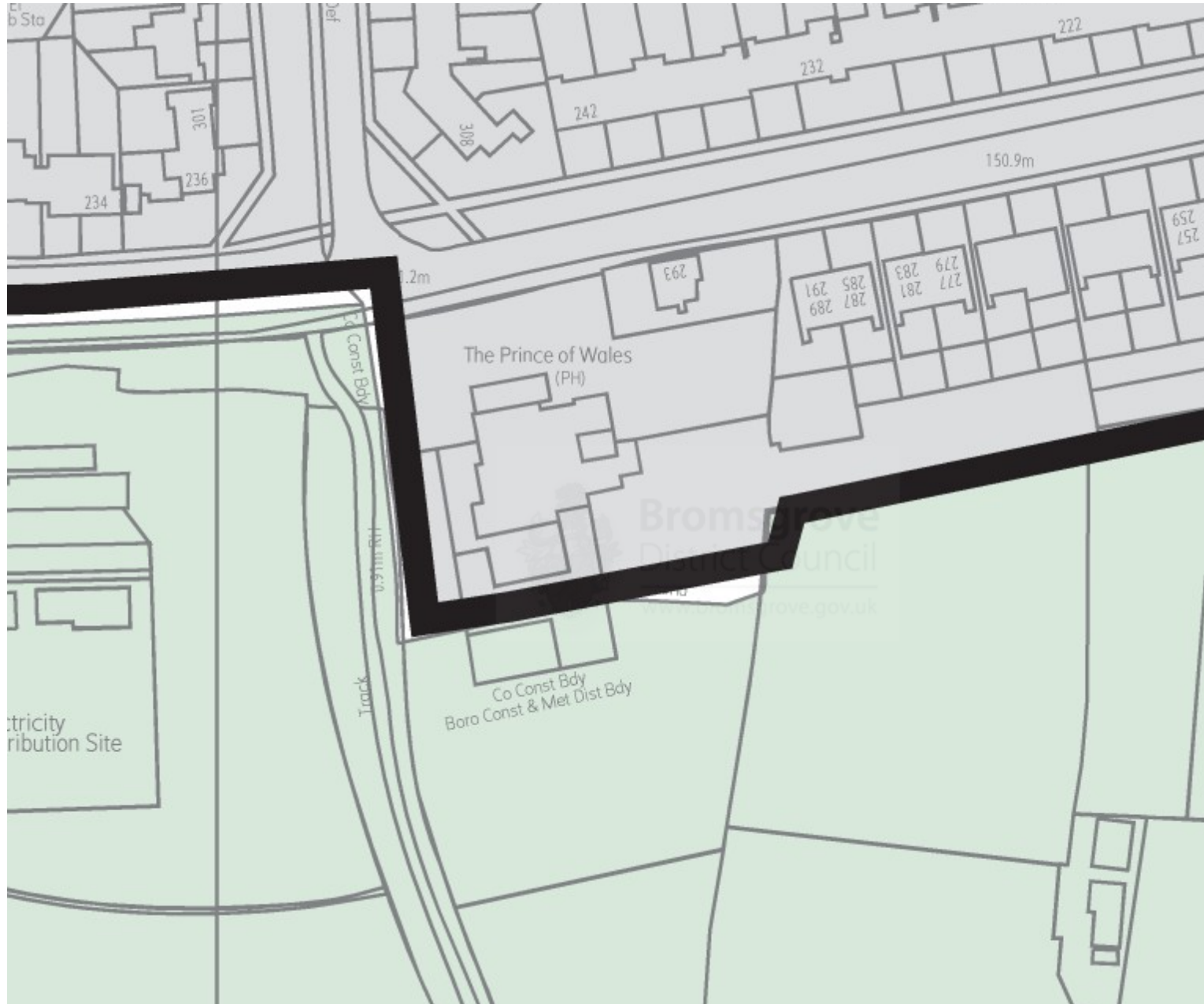

Proposed Site Plan

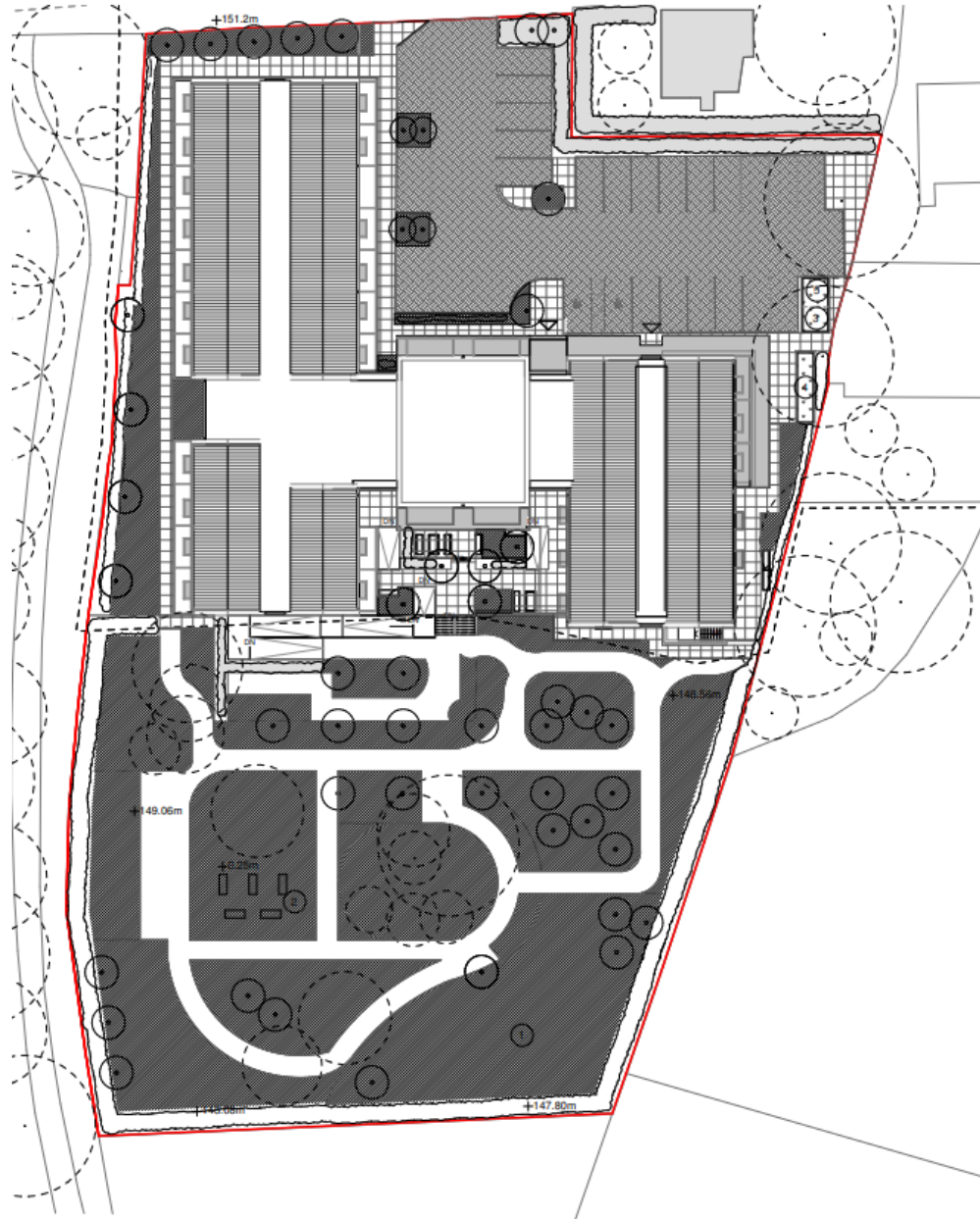

Aerial Photograph of Site



Proposed front and rear elevations



Proposed side elevations



Street Elevation AA
Scale 1 : 200



Street Elevation BB
Scale 1 : 200